

# HFP

## Applications

HFP hydro-cyclone filter is suitable for the first irrigation of water from wells, rivers and lakes, with a considerable amount of suspended sand and/or solids. The tangential inflow of water generates a whirling motion with a centrifugal movement which enables the separation between water and heavy particles. Due to the difference in density and specific gravity, the water will come out from the top while the heavier sand will precipitate to the center of the whirlpool accumulating in the appropriate recipient. On the bottom of the cone there is a TPU reduction that protects the filters from wear caused by the abrasive action of the sand. The separated sand can be discharged through the ball valve located on the tank.

## Materials

- Body: glass fiber reinforced polyamide
- Tank: glass fiber reinforced polyamide
- Closing element: clamp and bolts in AISI 304 stainless steel
- Gaskets: NBR

## Characteristics

- Maximum working pressure: 6 bar
- Types of connection: threaded
- The filter is supplied with a purge valve



## Load loss\*

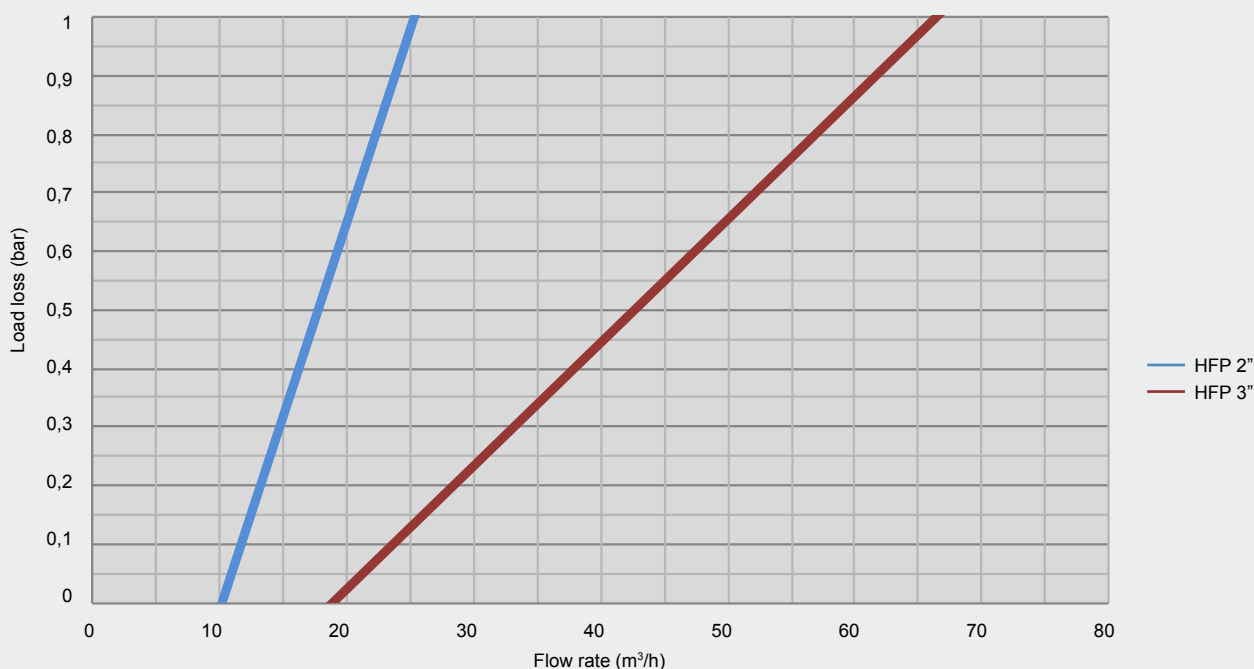

\*Testing for load loss was carried out with clean water.

# HFP

## Technical data

Couplings	Pricelist ref.	Ø body (mm)	Flow rate (m³/h)	Filtration area (cm²)
2"	<b>IFHFPG00M2V0N</b>	206	15-25	-
3"	<b>IFHFPI00M2V0N</b>	248	35-52	-

## Dimensions

ø (inches)	H (mm)	H1 (mm)	A (mm)	B (mm)	L (mm)	Weight (kg)
2	940	808	206	151	395	7,6
3	990	868	248	175	482	9,6

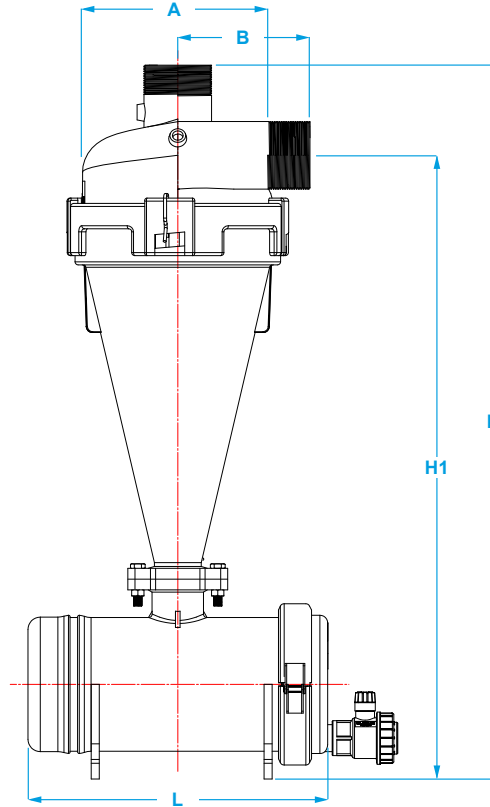

## Components

Number	Description
1	body (BSP thread)
2	brass bush
3	cone
4	small o-ring (cone)
5	big o-ring (cone)
6	stainless steel pin lock
7	tank (8 lt mod.2" - 10 lt mod.3")
8	o-ring (tank)
9	gasket (tank)
10	tank cover
11	stainless steel clamp
12	10 mm nut
13	bolt (10x50)
14	10 mm washer
15	rubber washer
16	interchangeable coupling
17	cone coupling
18	tank support
19	ball valve

